

MATERIAL CONSTRUCTION

SR.NO	DESCRIPTION	MATERIAL	QTY.
1	BODY	SA 234 GR.WPB / A 403 GR. WP 304/ A 403 GR. WP 316	1
2	BODY FLANGE	ASTM A 105 / A 182 GR. F 304/ A 182 GR. F 316	1
3	COVER FLANGE	ASTM A 105 / A 182 GR. F 304/ A 182 GR. F 316	1
4	IN-OUT NOZZLE FLANGE	ASTM A 105 / A 182 GR. F 304/ A 182 GR. F 316	2
5	ELEMENT	SS 304 / SS 316	1
6	COVER GASKET	SS 316 SPIRAL WOUND GRAPHITE FILLER	1
7	STUD & NUT	ASTM A 193/A 194 GR. B7/2H (ZINC PLATED)	---
8	VENT	ASTM A 105 / A 182 GR. F 304/ A 182 GR. F 316	1
9	HANDLE	SS 304 / SS 316	1

DIMENSIONS

SIZE		A	B	C	D	VENT
INCH	MM					
1-1/2"	40	238	114	137	270	1/2" NPT
2"	50	254	127	146	279	1/2" NPT
3"	80	311	172	179	349	1/2" NPT
4"	100	362	210	205	413	1/2" NPT
5"	125	425	248	237	489	1/2" NPT
6"	150	464	286	257	540	1/2" NPT
8"	200	559	356	308	660	1/2" NPT
10"	250	635	432	348	762	3/4" NPT
12"	300	737	508	400	889	3/4" NPT
14"	350	813	559	441	991	3/4" NPT
16"	400	864	610	468	1067	3/4" NPT
18"	450	965	686	522	1194	3/4" NPT
20"	500	1051	762	568	1305	1" NPT
24"	600	1168	864	632	1473	1" NPT

NOTE :- ALL DIMENSIONS ARE IN mm IF NOT SPECIFIED.

CLIENT :-

P.O.No :-

SCALE :- NTS

SHEET :- 1:1

DRAWING No.

REV.

FILE :- 01

DATE :- 28/03/2026

AFS-2507-150#- STD 00

TITLE :- "T" TYPE STRAINER FLANGED ANSI 150#

PROJECTION :-



PLOT NO-152/2
ROAD-5,
G.I.D.C.KATHWADA,
AHMEDABAD.

	NAME	DATE
ACAD BY	GPP	28/03/2026
CHED BY	GPP	28/03/2026
APPD BY	APT	28/03/2026

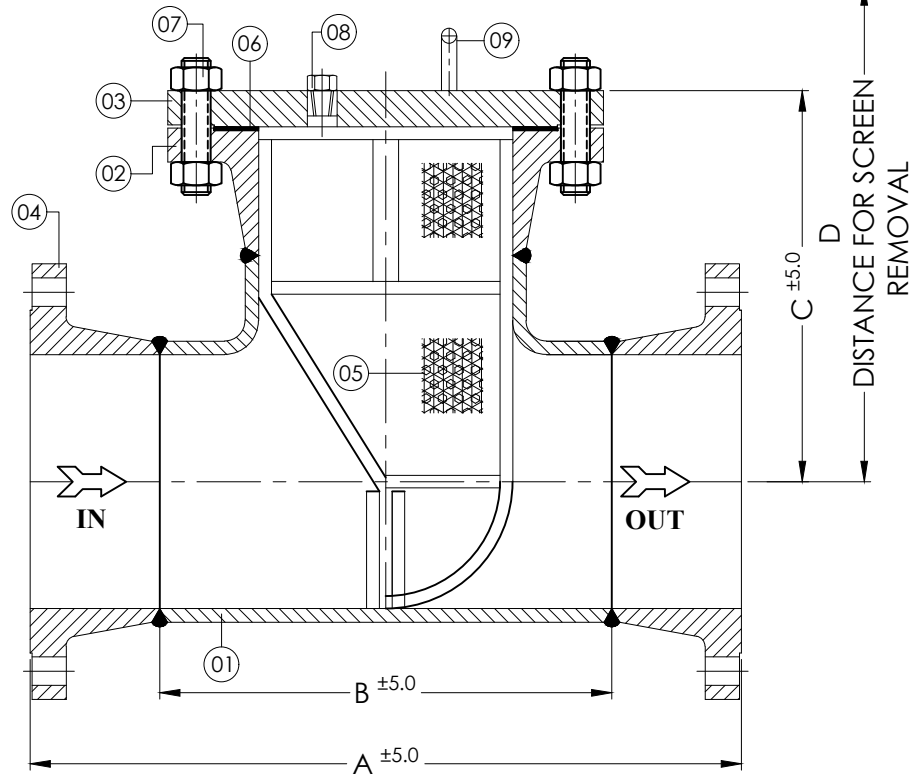
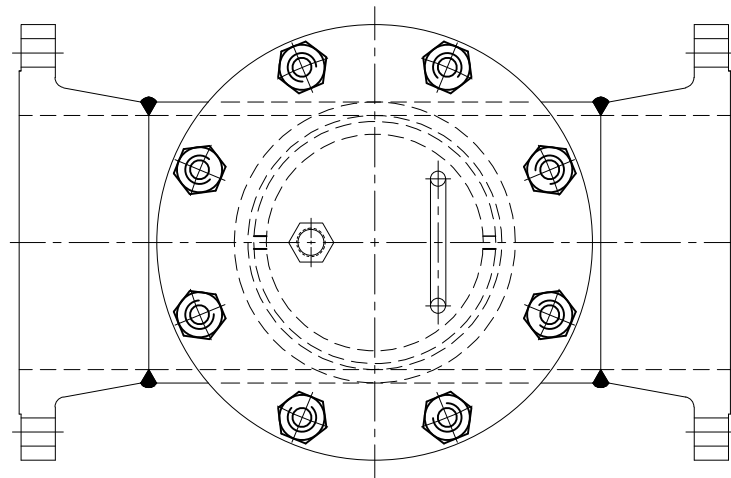

MATERIAL CONSTRUCTION

SR.NO	DESCRIPTION	MATERIAL	QTY.
1	BODY	SA 234 GR.WPB / A 403 GR. WP 304/ A 403 GR. WP 316	1
2	BODY FLANGE	ASTM A 105 / A 182 GR. F 304/ A 182 GR. F 316	1
3	COVER FLANGE	ASTM A 105 / A 182 GR. F 304/ A 182 GR. F 316	1
4	IN-OUT NOZZLE FLANGE	ASTM A 105 / A 182 GR. F 304/ A 182 GR. F 316	2
5	ELEMENT	SS 304 / SS 316	1
6	COVER GASKET	SS 316 SPIRAL WOUND GRAPHITE FILLER	1
7	STUD & NUT	ASTM A 193/A 194 GR. B7/2H (ZINC PLATED)	---
8	VENT	ASTM A 105 / A 182 GR. F 304/ A 182 GR. F 316	1
9	HANDLE	SS 304 / SS 316	1

DIMENSIONS

SIZE		A	B	C	D	VENT
INCH	MM					
1-1/2"	40	238	114	137	270	1/2" NPT
2"	50	254	127	146	279	1/2" NPT
3"	80	311	172	179	349	1/2" NPT
4"	100	362	210	205	413	1/2" NPT
5"	125	425	248	237	489	1/2" NPT
6"	150	464	286	257	540	1/2" NPT
8"	200	559	356	308	660	1/2" NPT
10"	250	635	432	348	762	3/4" NPT
12"	300	737	508	400	889	3/4" NPT
14"	350	813	559	441	991	3/4" NPT
16"	400	864	610	468	1067	3/4" NPT
18"	450	965	686	522	1194	3/4" NPT
20"	500	1051	762	568	1305	1" NPT
24"	600	1168	864	632	1473	1" NPT

NOTE :- ALL DIMENSIONS ARE IN mm IF NOT SPECIFIED.

CLIENT :-

P.O.No :-

SCALE :- NTS

SHEET :- 1:1

DRAWING No.

REV.

FILE :- 01

DATE :- 28/03/2026

AFS-2507-150#- STD 00

TITLE :- "T" TYPE STRAINER FLANGED ANSI 150#

PROJECTION :-



PLOT NO-152/2
ROAD-5,
G.I.D.C.KATHWADA,
AHMEDABAD.

	NAME	DATE
ACAD BY	GPP	28/03/026
CHED BY	GPP	28/03/026
APPD BY	APT	28/03/026