

ELEVATION

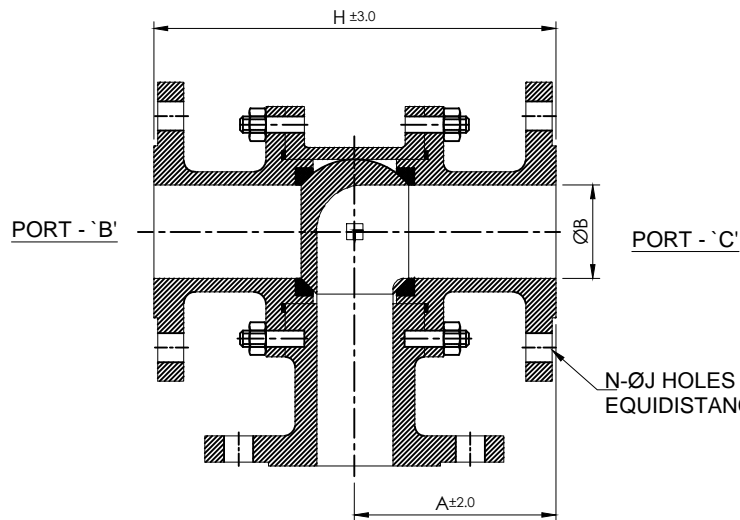

PORT - 'A'
TOP VIEW
(i) FLOW A TO C

PORT POSITION 'L' PORT VALVE

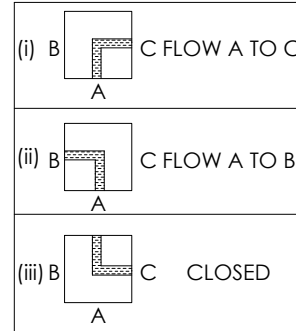

N-ØJ HOLES AT PCD.K ±1.5
EQUIDISTANCE, OFF CENT.

SR.NO	DESCRIPTION	MATERIAL	QTY.
1	BODY	ASTM A216 GR.WCB	1
2	END PIECES	ASTM A216 GR.WCB	2
3	BALL + STEM	ASTM A351 GR. CF8 + SS 304	1
4	GLAND	CARBON STEEL	1
5	SEAT	PTFE	2
6	GASKET	PTFE	2
7	GLAND PKG.	PTFE	SET
8	STUD & NUT	CARBON STEEL	SET
9	LEVER	CARBON STEEL	1

TECHNICAL DATA:

MFG.STD : BS 5351
 INSP. STD : BS 6755,PART-1
 END FLANGE STD : ANSI B 16.5 150# FR
 HYD. TESTING a)BODY : 30 BAR
 b)SEAT : 21BAR
 PN.TESTING a)BODY : 06BAR

DIMENSIONS										
SIZE	ØA	ØB	ØC	ØD	T	N - ØJ	ØK.PCD	H	H1	L
25MM	87.5	25	50.8	110	9.6	4 - 15.9	79.4	175		230
40MM	100	38	73	125	12.7	4 - 15.9	98.4	200	120	200
50MM	125	50	92.1	150	14.3	4 - 19.05	120.7	250		355
65MM	140	65	104.8	180	15.9	4 - 19.05	144	280		400
80MM	155	76	127	190	17.5	4 - 19.05	152.4	310	170	485
100MM	175	102	157.2	230	23.3	8 - 19.05	190.5	350		575
150MM	197.5	152	215.9	280	23.9	8 - 22.2	241.3	395		

NOTE :- 1. ALL DIMENSIONS ARE IN mm IF NOT SPECIFIED.

CLIENT :-		QTY. :-	
P.O.NO :-		W.O.NO:-	
SCALE :- NTS	SHEET :-	DRAWING No.	REV.
FILE :-	DATE :-28/09/2015	AFS-2529-150#-STD	00
TITLE :- 3 WAY BALL VALVE ANSI 150# FLANGED ENDS		PROJECTION :-	
 ACME FLUID SYSTEMS www.strainersindia.com	PLOT NO-152/2, ROAD NO-5, G.I.D.C. KATHWADA, AHMEDABAD.	NAME	DATE
		ACAD BY GPP	28/09/15
		CHED BY GPP	28/09/15
		APPD BY APT	28/09/15